

Cranked handles with retractable handle

Aluminium

SPECIFICATION

Body

- Aluminium
- plastic coated, black, textured finish
- hub machined

Retractable handles GN 598.3 (see page 585)

Plastic, Duroplast
black, shiny finish

Retractable mechanism
Steel, blackened



INFORMATION

The handpiece of cranked handles GN 471.3 is locked in a tapered bore in the operating position.

For tilting, the handle must first be pulled out of the taper in axial direction.

A compression spring holds the handle in both end positions. When folded out, it automatically re-engages.

ON REQUEST

- with retractable handle GN 598.5 (retractable mechanism Stainless Steel) (see page 585)

TECHNICAL INFORMATION

- Square DIN 79 (see page A16)
- Cross holes GN 110 (see page A17)
- ISO-Fundamental Tolerances (see page A21)

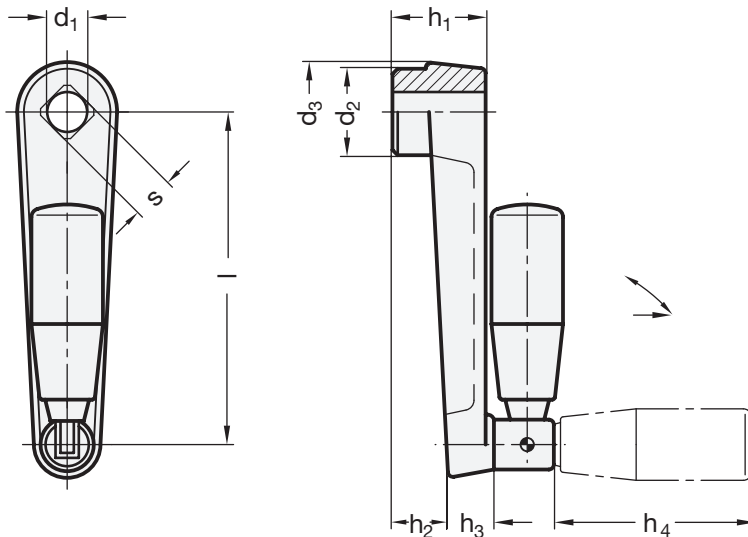

GN 471.3

Description	l	d1 H7	s H11	d2	d3	h1	h2	h3	h4 ≈	Ø Handle	⚖
GN 471.3-100-B12	100	B 12	-	27	30	28	17	13	67.5	23	199
GN 471.3-100-V12	100	-	V 12	27	30	28	17	13	67.5	23	194
GN 471.3-125-B14	125	B 14	-	32	35	34	22	14	67.5	23	254
GN 471.3-125-V14	125	-	V 14	32	35	34	22	14	67.5	23	247
GN 471.3-160-B17	160	B 17	-	35	39	38	26	16	82.5	26	346
GN 471.3-160-V17	160	-	V 17	35	39	38	26	16	82.5	26	340

